

Murray Scholls Town Center

14795 SW Murray Scholls DR.
Beaverton, OR 97007

Suite 200: approximately 38,800 (Divisible from 4,236 rsf to 38,800 rsf)



Murray Scholls Town Center

14795 SW Murraray Scholls Dr | Beaverton, OR 97007

For Lease

Property Description

Murray Scholls Town Center is located at the corner of southwest Scholls Ferry Road and Murray Boulevard and is one of the most diverse mixed use developments in the Portland, Metro area. The property is located less than a mile from affluent communities of Tigard's Bull Mountain and Beaverton's Murrayhill. The office space now offered provides all the benefits of working from home and the office with access to outdoor deck areas, opportunities for fitness, healthcare and retail.

Current Tenants include: 24-Hour Fitness, Walgreens, Beaverton City Library, Murray Scholls Vision Center, Chipotle, Chevron, Starbucks, Café Murrayhill, Five Guys Burger and Fries, Pizzicato and the Murrayhill Taphouse. There are walking paths throughout the development and lakeside views.



38k

Sqaure Feet

4/1000

Parking

2000

Year Built



Murray Scholls Town Center

14795 SW Murray Scholls Dr | Beaverton, OR 97007

For Lease

Suite 200

Approximately 38,800 (Divisible from 4,236 rsf to 38,800 rsf)

The current office suite offering is located at 14795 SW Murray Scholls Drive in Suite 200. The suite may be demised but has beautiful creative finishes featuring polished concrete, high ceiling heights and unique treatments throughout the space

- \$27-\$30/rsf full service
- Washington County address
- 4/1000 parking
- Beautiful exterior patio
- Mixed use setting with many amenities and services for convenience
- Expansive windowline
- Polished concrete and modern creative finishes throughout

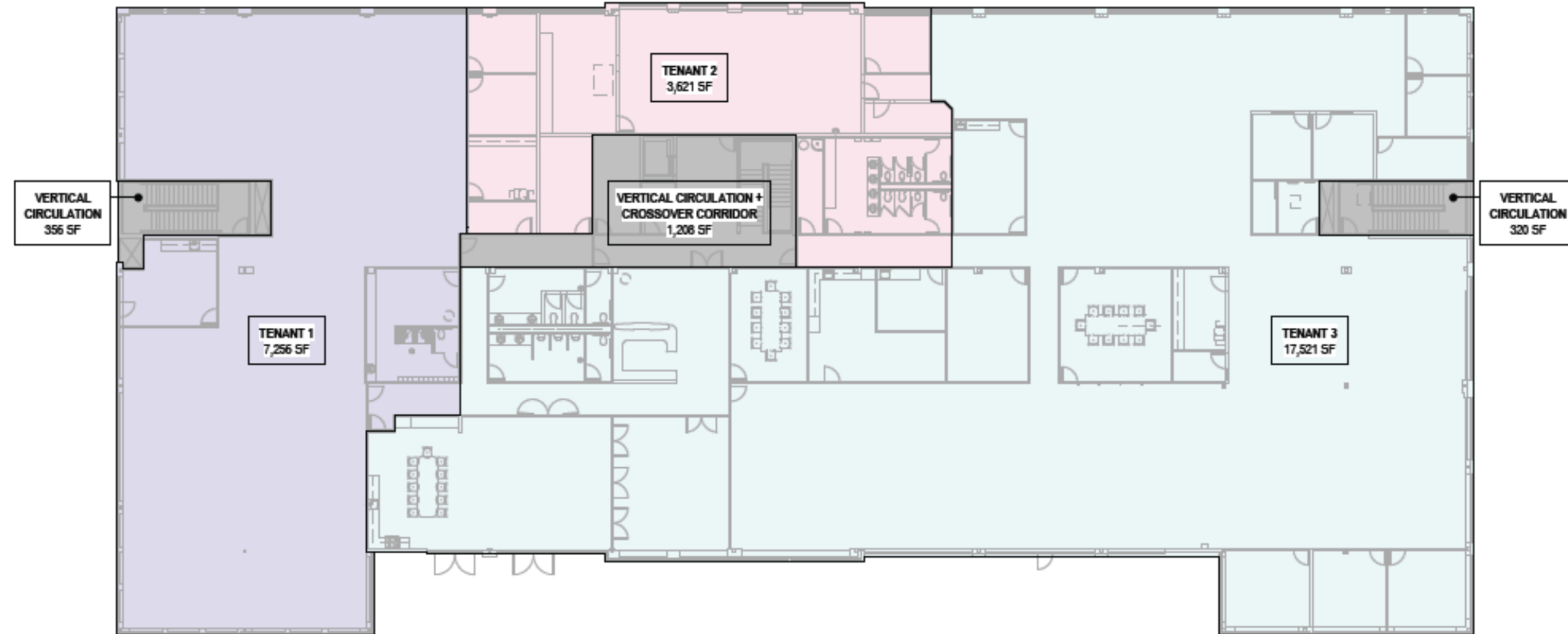

Murray Scholls Town Center

14795 SW Murraray Scholls Dr. | Beaverton, OR 97007

For Lease



Contact Us

Jennifer Medak
First Vice President
+1 503 221 4853
jennifer.medak@cbre.com

© 2021 CBRE, Inc. All rights reserved. This information has been obtained from sources believed reliable, but has not been verified for accuracy or completeness. You should conduct a careful, independent investigation of the property and verify all information. Any reliance on this information is solely at your own risk. CBRE and the CBRE logo are service marks of CBRE, Inc. All other marks displayed on this document are the property of their respective owners, and the use of such logos does not imply any affiliation with or endorsement of CBRE. Photos herein are the property of their respective owners. Use of these images without the express written consent of the owner is prohibited.

www.cbre.com/portland

The CBRE logo, consisting of the letters "CBRE" in a bold, green, sans-serif font.